

Manufacturing Headquarters
 3001 Darrell Road
 Island Lake, IL 60042
 ph: 847-526-2166
 fax: 847-526-2241
 toll free: 800-323-1659

West Texas Sales
 1000 West 2nd Street
 Odessa, TX 79763
 ph: 432-301-9990
 fax: 432-301-9991



www.kempervalue.com

Arkansas Sales
 180 Sherman Way
 Kensett (Searcy), AR 72082
 ph: 501-268-2698
 fax: 501-268-2196

National Sales Headquarters
 12343 Cutten Road
 Houston, TX 77066
 ph: 281-781-2730
 fax: 281-781-2731
 toll free: 800-231-2724

Pennsylvania Sales
 111 Arrowhead Drive, Unit C
 Slippery Rock, PA 16057
 ph: 724-738-0130
 fax: 724-738-0172

South Texas Sales
 1391 County Road 429
 Pleasanton, TX 78064
 ph: 210-446-5863
 fax: 830-569-8236

Rocky Mountain Sales
 1423 4th Avenue
 Grand Junction, CO 81501
 ph: 970-609-5845
 fax: 970-609-5839

Utah Sales
 1243 East Highway 40, Unit 1
 Vernal, UT 84078
 ph: 435-781-8258
 fax: 435-781-3037

Canada Sales
 8001 Edgar Industrial Avenue
 Red Deer, Alberta T4P 3S2
 ph: 403-348-0872
 fax: 403-348-0873

Mid-Continent Sales
 2733 Industrial Drive
 Sulphur, OK 73086
 ph: 580-247-9623
 fax: 580-622-2058
 toll free: 888-533-3722



OPTIONAL CAP WITHOUT HOIST RING SEE PARTS LIST ITEM 16

FLAPPER: ALL METAL DESIGN; NO RUBBER

ITEM 9 IS A REPLACEABLE PART; SEE REPAIR KIT

O-RING SEAL NOT IN DIRECT PATH OF FLOW; WILL LAST LONGER

ITEM	DESCRIPTION	1"	QTY.	2"	QTY.	3"	QTY.	4"	QTY.
1	HAMMER LUG-NUT					150393	1		
2	SEGMENTED RING					150397	1		
3	RETAINING RING					150396S6	1		
4	BODY					NOT AVAIL. FOR INDIVIDUAL SALE	1		
5	FILLER BLOCK					3SC15-00-FB-C-35	1		
6	UNION SEAL RING					620395B	1		
7	O-RING 2-234					OR-18-300-BN-90-234	1		
8	O-RING 2-237					OR-18-338-BN-90-237	1		
9	SEAT INSERT					3SC15-00-SI-M-17	1		
10	RETAINER CRADLE ASSY					3SC15-00-RT-35-A	1		
11	FLAPPER					3SC15-00-FL-M	1		
12	O-RING 2-254					OR-18-512-BN-90-254	1		
13	CAP FOR HOIST RING					3SC15-00-CP-M-56-HR	1		
14	HOIST RING					HRNG-V-0001	1		
15	CAP					3SC15-00-CP-M-56-00	1		

NOTE: FOR SOUR GAS SERVICE COMPONENTS PLEASE CONSULT FACTORY. 1", 2" + 4" NOT AVAILABLE YET.

● = INDICATES P/N USED IN REPAIR KITS
 □ = INDICATES P/N USED IN SEAL KITS

SWING CHECK VALVE ASSEMBLY PART NUMBERS		
PART NO.	DESCRIPTION	WT.
3SC15-00-SD-ST-00-A	SWING CHECK VALVE - 3" FIG 1502 - STD FLOW ASSEMBLY W/OUT HOIST RING	155 lbs
3SC15-00-SD-RV-00-A	SWING CHECK VALVE - 3" FIG 1502 - REV FLOW ASSEMBLY W/OUT HOIST RING	155 lbs
3SC15-00-SD-ST-HR-A	SWING CHECK VALVE - 3" FIG 1502 - STD FLOW ASSEMBLY W/ HOIST RING	155 lbs
3SC15-00-SD-RV-HR-A	SWING CHECK VALVE - 3" FIG 1502 - REV FLOW ASSEMBLY W/ HOIST RING	155 lbs

DIMENSIONS ARE THE SAME FOR STANDARD OR REVERSE FLOWCHECK VALVES WITH OR WITHOUT THE HOIST RING OPTION

SWING CHECK						
SIZE	A	B	C	D	E	F
1" FIG 1502 √						
2" FIG 1502 √						
3" FIG 1502 *	16.00"	11.00"	8.50"	2.63"	4.52"	14.56"
4" FIG 1502 √						

* = FOR FIG 602 OR 1002 CONSULT FACTORY
 √ = NOT RELEASED; CONSULT FACTORY

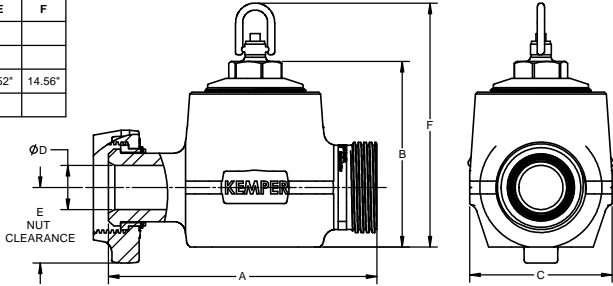

1" SWING CHECK VALVE KITS		
PART NO.	DESCRIPTION	WT.
2" SWING CHECK VALVE KITS		
3" SWING CHECK VALVE KITS		
□	3SC15-BN-90-KS	SEAL KIT 0.1 lbs
●	3SC15-35-17-BN-90-KR	REPAIR KIT 4.5 lbs
	3SC15-35-BN-90-KF	FLAPPER KIT 2.1 lbs
4" SWING CHECK VALVE KITS		

KITS ARE THE SAME FOR STANDARD OR REVERSE FLOW CHECK VALVES

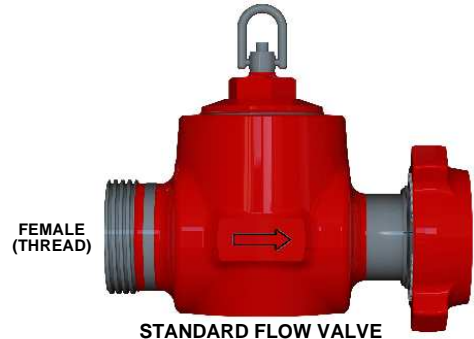

STANDARD FLOW VALVE
 FEMALE INLET ; MALE OUTLET
 NOTE THE DIRECTION OF THE ARROW

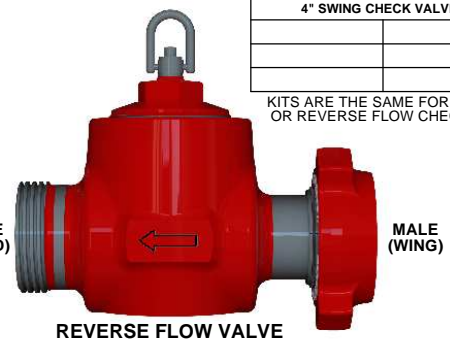

REVERSE FLOW VALVE
 FEMALE OUTLET ; MALE INLET
 NOTE THE DIRECTION OF THE ARROW

SWING CHECK VALVES